

LF Series

Square Linear/Louvre Actuator

Force 600N Max Stroke 1000mm



Features

- Can be used for openings for smoke exhaust and daily natural ventilation
- Suitable for top/bottom/side hung window/skylight and driving louvres as well
- In accordance with EN12101-2 standard
- Housing material: Al alloy; pulling shaft material: stainless steel
- Electronic overload cutoff
- Multi bracket options for different installations
- Lifetime: more than 30,000 times of opening and closing
- Standard housing finish is anodized silver, other colors are available by painting
- Built-in synchronization module can be added to make 2 actuators work in tandem

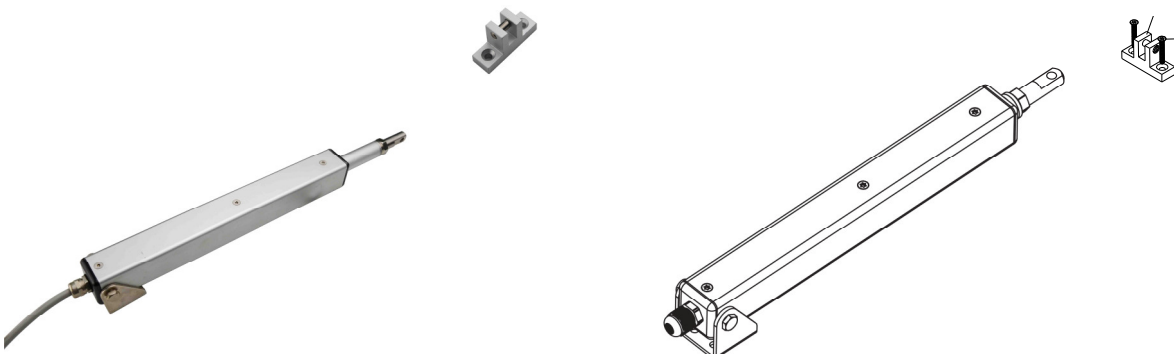

LF Series

Square Linear/Louvre Actuator

Force 600N Max Stroke 1000mm

Parameters

	24V	220V
Voltage	DC24V±10%	AC220V±10%
Cutoff Current	1.0A	0.15A
Force	600N	600N
Speed	6mm/s	6mm/s
Stroke	50~1000mm	50~1000mm
Temperature	-20~75℃	-20~75℃
Protection Class	IP54	IP54
Electric Connection	2 wires	3 wires + earth
Limit Stop	Electronic	Electronic

Dimensions in mm

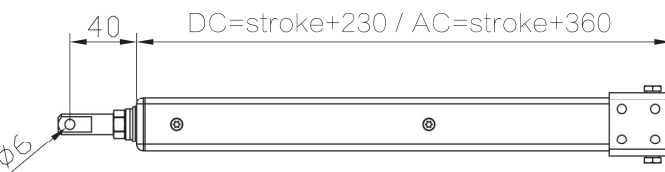
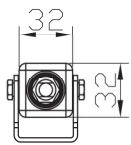

Wiring Diagram

	Open	Close
Brown	LA	
Black		LB
Blue	N	N
green-yellow		⊥

**AC220V
Wiring**

	Open	Close
Brown	+	-
Blue	-	+

**DC24V
Wiring**

Optional Accessories



LF-T1

End bracket,
fixed on the tube

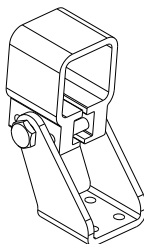

LF-T2

Can be fixed at any
position of tube



LF-T3

End Bracket, fixed on the end cap and cable
goes out from one side of the tube